

HS1175 ADDENDUM



HS1175

OWNER'S MANUAL
ADDENDUM

READ THIS FIRST!

**THE FOLLOWING PAGES WILL SUPERCEDE
THE EXISTING PAGES IN THE
HS1175 MANUAL**

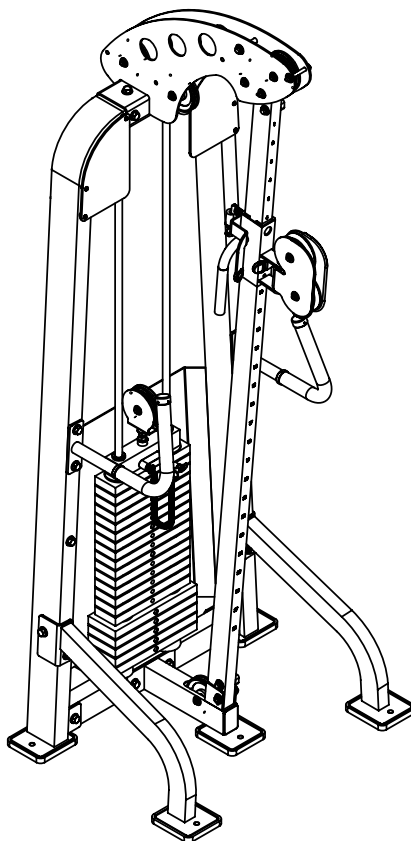

Note: Both Serial Number and Model Number are Required when Ordering Parts

RECORD SERIAL NUMBER HERE

CATALOG NUMBER

0106 - 000

Customer Service

(800) 548-5438

(858) 578-7676

Fax

(858) 578-9558

OWNERS MANUAL

FRAME ASSEMBLY STEP 2d

| ITEM NO. | PART NUMBER | DESCRIPTION |
|----------|-------------|----------------------------------|
| 1 | 026-01X2029 | TOP FRAME ASSEMBLY |
| 2 | 026-01X1487 | FRAME UPRIGHT |
| 45 | 013-0102003 | 1/2" X 27mm SAE FLAT WASHER (WZ) |
| 47 | 012-0304011 | 1/2"-13UNC THIN NYLOCK NUT (WZ) |
| 50 | 011-0407014 | 1/2"-13UNC X 5.00" HHB (WZ) |

OWNERS MANUAL

FRAME ASSEMBLY STEP 2h

| ITEM NO. | PART NUMBER | DESCRIPTION |
|----------|-------------|----------------------------------|
| 2 | 026-01X1487 | FRAME UPRIGHT |
| 13 | 026-01X2031 | LEFT HANDLE |
| 14 | 026-01X2035 | RIGHT HANDLE |
| 45 | 013-0102003 | 1/2" X 27mm SAE FLAT WASHER (WZ) |
| 47 | 012-0304011 | 1/2"-13UNC THIN NYLOCK NUT (WZ) |
| 50 | 011-0407014 | 1/2"-13UNC X 5.00" HHB (WZ) |

OWNERS MANUAL

FRAME ASSEMBLY STEP 2j

| ITEM NO. | PART NUMBER | DESCRIPTION |
|----------|--------------|----------------------------------|
| 2 | 026-01X1487 | FRAME UPRIGHT |
| 43 | 026-1100189 | FRAME SHIELD |
| 44 | 011-0107030 | 1/2"-13UNC X 3.00" HHB (WZ) |
| 45 | 013-0102003 | 1/2" X 27mm SAE FLAT WASHER (WZ) |
| 46 | 013-0402005 | 3/8" X 25mm USS FLAT WASHER (WZ) |
| 47 | 012-0304011 | 1/2"-13UNC THIN NYLOCK NUT (WZ) |
| 48 | 012-0104008 | 3/8"-16UNC THIN NYLOCK NUT (WZ) |
| 50 | 011-0407014 | 1/2"-13UNC X 5.00" HHB (WZ) |
| 53 | 011-0407055 | 1/2"-13UNC X 4.75" HHB (WZ) |
| 55 | 011-0107047 | 3/8"-16UNC X 3.00" HHB (WZ) |
| 69 | 026-01PL0290 | WHITE SPACER |
| 70 | 013-0002003 | 1/4" X 13mm SAE FLAT WASHER (WZ) |
| 71 | 012-0104009 | 1/4"-20UNC THIN NYLOCK NUT (WZ) |
| 72 | 011-0101074 | 1/4"-20UNC X 5.00" BHCB (WZ) |
| 73 | 021-0013185 | HS1175 PLACARD |
| 74 | 021-0013184 | HS1175 PLACARD |

OWNERS MANUAL

DECAL PLACEMENT

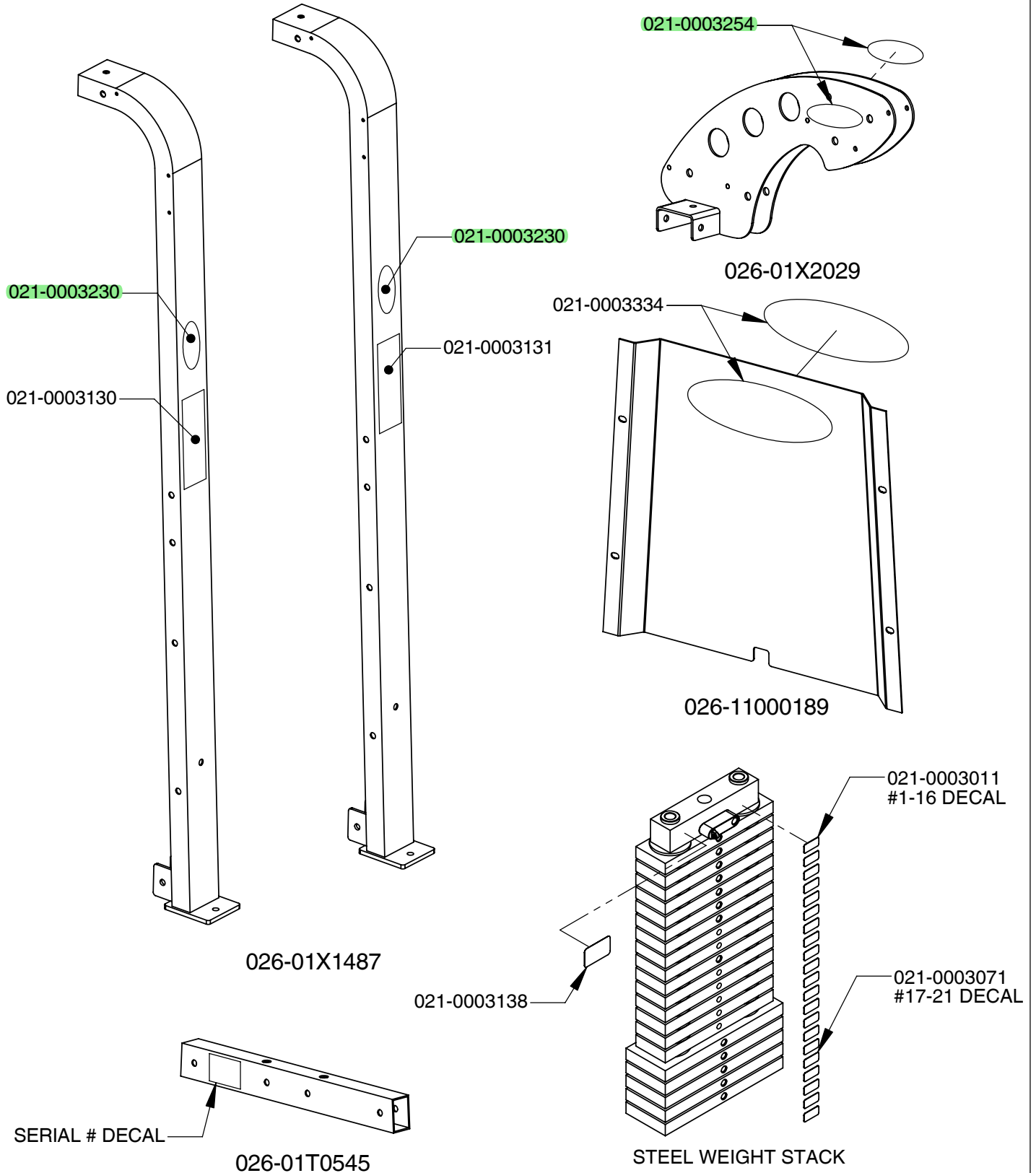

OWNERS MANUAL



021-0003230



021-0003254



021-0003138



021-0003334



021-0003071



SERIAL # DECAL



021-0003011

| Yearly | Monthly | Weekly | Daily | COMMERCIAL MAINTENANCE |
|--------|---------|--------|-------|--|
| | | | X | Inspect; Lanes, Pull Pins, Spring Loaded Straps, Weight Stack Pins |
| | | | X | Clean; Upholstery |
| | | | X | Inspect; Cables or Belts and their tension |
| | | X | | Inspect; Accessory Bars and Handles |
| | | X | | Inspect; All Decals |
| | | X | | Inspect; All Nuts and Bolts, Tighten if Needed |
| | | X | | Inspect; Anti-Skid Surfaces |
| | | X | | Clean & Lubricate; Guide Rods with a Teflon (PTFE) based lubricant (Superlube) |
| | | X | | Lubricate; Sprockets, Turbine Bushings, Linear Bearings |
| | | X | | Clean and Wax; All Glossy Finishes |
| | | X | | Repack with Grease; Linear Bearings |
| | | | | Replace; Cables, Belts and Connecting Parts |

NOTICE

021-0003131

WARNING
USE ONLY GENUINE HOIST REPLACEMENT PARTS. FAILURE TO DO SO WILL VOID WARRANTY AND COULD RESULT IN PERSONAL INJURY OR EVEN DEATH. THERE IS A RISK ASSUMED BY INDIVIDUALS WHO USE THIS TYPE OF EQUIPMENT. USE THIS TYPE OF EQUIPMENT. ALWAYS FOLLOW THESE SIMPLE RULES:

1. READ & UNDERSTAND ALL ENCLOSED INSTRUCTIONS before using this equipment.
2. INSPECT EQUIPMENT BEFORE EACH USE. Replace all parts at the first signs of wear or damage. If in doubt about a certain part, DO NOT use the equipment until the part is replaced. Failure to replace worn or damaged parts may result in injury.
3. FOLLOW ROUTINE MAINTENANCE SCHEDULE
4. CONSULT YOUR PHYSICIAN BEFORE STARTING ANY EXERCISE PROGRAM. Warm up properly before engaging in weight resistance training. Stop exercising if you feel faint or dizzy.
5. TO PREVENT THE POSSIBILITY OF SERIOUS INJURY, KEEP CLEAR OF ALL MOVING PARTS. Do not attempt to free any jammed part by yourself. Obtain assistance in order to avoid possible injury.
6. Take your time and do not rush the exercise. Practice proper breathing. NEVER hold your breath.
7. CHILDREN SHOULD NOT BE ALLOWED TO USE THIS EQUIPMENT. To avoid possible injury, children should be kept at a safe distance when this equipment is in use. Teenagers should not use this equipment without adult supervision.
8. CALL YOUR AUTHORIZED DISTRIBUTOR if you have any questions on the proper use or maintenance of this equipment.

021-0003130



OWNERS MANUAL

PART LIST

NOTE: SOME OF THESE PARTS MAY COME PRE-INSTALLED

| ITEM NO. | PART NUMBER | DESCRIPTION | QTY |
|----------|--------------|--|-----|
| 1 | 026-01X2029 | TOP FRAME ASSEMBLY | 1 |
| 2 | 026-01X1487 | FRAME UPRIGHT | 2 |
| 3 | 026-01X0817 | REAR TIE ASSEMBLY | 1 |
| 4 | 026-01PL0195 | RUBBER FOOT PAD | 6 |
| 5 | 026-01T0545 | WEIGHT STACK MOUNT | 1 |
| 6 | 026-01X2032 | FRONT FRAME MOUNT | 1 |
| 7 | 026-01X2033 | SLIDE ASSEMBLY | 1 |
| 8 | 026-01PL0125 | E-Z GLIDE PLASTIC SLEEVE | 2 |
| 9 | 026-01T2041 | PULLEY MOUNT ADJUSTER TUBE | 1 |
| 10 | 019-0002015 | 1.00" DIA. X 6.00" LG. CLOSED END GRIP | 1 |
| 11 | 026-01PL0239 | THUMB LATCH | 3 |
| 12 | 026-01P0819 | GUIDE ROD TOP PLATE | 1 |
| 13 | 026-01X2031 | LEFT HANDLE | 1 |
| 14 | 026-01X2035 | RIGHT HANDLE | 1 |
| 15 | 018-0001003 | 4.50" DIA. CABLE PULLEY | 6 |
| 16 | 026-01X0867 | LEFT SIDE SUPPORT | 1 |
| 17 | 026-01X0868 | RIGHT SIDE SUPPORT | 1 |
| 18 | 016-0201015 | END CAP-F 2.00" X 3.00" (BLACK) | 2 |
| 19 | 026-01PL0221 | PLASTIC LIMITER | 2 |
| 20 | 026-01X2034 | THUMB LATCH RELEASE | 1 |
| 21 | 026-01M0760 | HEAVY FLANGED SPACER .391" I.D. X .50" LG. | 2 |
| 22 | 026-01X1071 | SWIVEL PULLEY HOUSING | 1 |
| 23 | 014-0003003 | .50" FLANGED BALL BEARING | 2 |
| 24 | 018-0002012 | Ø 4.50" WIDE GROOVE PULLEY | 2 |
| 25 | 019-0001005 | WEIGHT STACK BUMPER | 2 |
| 26 | 012-0202001 | 1/2"-13 FLANGED NUT (WZ) | 2 |
| 27 | 030-0303010 | ROLL PIN .438" DIA. X 2.75" LG. | 2 |
| 28 | 026-01G0178 | GUIDE ROD | 2 |
| 29 | 026-01PL0134 | GUIDE ROD BUSHING | 2 |
| 30 | 026-01PL0291 | LANYARD/SELECTOR PIN STAND OFF | 1 |

OWNERS MANUAL

PART LIST CONTINUED

NOTE: SOME OF THESE PARTS MAY COME PRE-INSTALLED

| ITEM NO. | PART NUMBER | DESCRIPTION | QTY |
|----------|--------------|---|-----|
| 31 | 026-01W0110 | 21 HOLE WEIGHT STEM | 1 |
| 32 | 026-01M0134 | SELECTOR PIN | 1 |
| 33 | 026-01PL0141 | T-HANDLE W/ HOLE | 1 |
| 34 | 010-0008001 | LANYARD COIL | 1 |
| 35 | 026-01X2026 | ADJUSTABLE PULLEY MOUNT | 1 |
| 36 | 026-1300034 | 8.25 LB TOP WEIGHT PLATE | 1 |
| 37 | 026-01W0101 | 12.50 LB STEEL WEIGHT PLATE | 5 |
| 38 | 026-01W0102 | 8.25 LB INTERMEDIATE WEIGHT PLATE | 15 |
| 39 | 026-01W0122 | WEIGHT PLATE BUSHING | 40 |
| 40 | 026-01M0309 | LATCH PIN | 1 |
| 41 | 014-0015001 | .25" C-CLIP | 1 |
| 42 | 026-01M0598 | .25" FLANGED SPACER | 2 |
| 43 | 026-1100189 | FRAME SHIELD | 1 |
| 44 | 011-0107030 | 1/2"-13UNC X 3.00" HHB (WZ) | 5 |
| 45 | 013-0102003 | 1/2" X 27mm SAE FLAT WASHER (WZ) | 42 |
| 46 | 013-0402005 | 3/8" X 25mm USS FLAT WASHER (WZ) | 11 |
| 47 | 012-0304011 | 1/2"-13UNC THIN NYLOCK NUT (WZ) | 22 |
| 48 | 012-0104008 | 3/8"-16UNC THIN NYLOCK NUT (WZ) | 11 |
| 49 | 011-0002046 | 1/2"-13UNC X 2.50" FHB (WZ) | 2 |
| 50 | 011-0407024 | 1/2"-13UNC X 5.00" HHB (WZ) | 8 |
| 51 | 011-0407024 | 1/2"-13UNC X 2.75" HHB (WZ) | 2 |
| 52 | 011-0407018 | 1/2"-13UNC X 2.50" HHB (WZ) | 1 |
| 53 | 011-0407055 | 1/2"-13UNC X 4.75" HHB (WZ) | 2 |
| 54 | 011-0107026 | 3/8"-16UNC X 2.25" HHB (WZ) | 2 |
| 55 | 011-0107047 | 3/8"-16UNC X 3.00" HHB (WZ) | 6 |
| 56 | 011-0107032 | 3/8"-16UNC X 2.50" HHB (WZ) | 1 |
| 57 | 011-0407020 | 3/8"-16UNC X 1.75" HHB (WZ) | 1 |
| 58 | 011-0107034 | 1/2"-13UNC X 3.25" HHB (WZ) | 2 |
| 59 | 026-01M0532 | .391" I.D. X .688" LG. HEAVY FLANGED SPACER | 8 |
| 60 | 026-01M0391 | END CAP ϕ 1.25" ALUM. | 2 |

OWNERS MANUAL

PART LIST CONTINUED

NOTE: SOME OF THESE PARTS MAY COME PRE-INSTALLED

| ITEM NO. | PART NUMBER | DESCRIPTION | QTY |
|----------|-----------------|-------------------------------------|-----|
| 61 | 026-01pl0235-01 | 1.425" OD X 1.188" ID OPEN END GRIP | 2 |
| 62 | 026-01M0392 | RING ϕ 1.25" ALUM. | 2 |
| 63 | 026-01M0588 | PIVOT SHAFT .50" DIA X 3.107" LG. | 1 |
| 64 | 011-0101026 | 3/8"-16UNC X 1.00" BHCS (WZ) | 2 |
| 65 | 013-0102022 | 3/8" INTERNAL LOCK WASHER | 2 |
| 66 | 013-0002004 | 3/8" X 21mm SAE FLAT WASHER (WZ) | 2 |
| 67 | 011-0311005 | 10-32 X 1/8" SET SCREW | 8 |
| 68 | 020-0011010 | CENTURY SPRING 3894 | 1 |
| 69 | 026-01PL0290 | WHITE SPACER | 6 |
| 70 | 013-0002003 | 1/4" X 16mm SAE FLAT WASHER (WZ) | 6 |
| 71 | 012-0104009 | 1/4"-20UNC THIN NYLOCK NUT (WZ) | 6 |
| 72 | 011-0101074 | 1/4"-20UNC X 5.00" BHCB (WZ) | 6 |
| 73 | 021-0013185 | HS1175 PLACARD | 1 |
| 74 | 021-0013184 | HS1175 PLACARD | 1 |
| 75 | 011-0311009 | 5/16"-18UNC X .31" SET SCREW (BZ) | 2 |
| 76 | 010-01C0299T | HS1175 WEIGHT STACK CABLE | 1 |
| 77 | 026-01M0200 | QUICK RELEASE CABLE LOCK | 1 |
| 78 | 026-01PL0311 | CABLE SWIVEL END BODY | 1 |
| 79 | 014-0012007 | #7300MB BEARING | 1 |
| 80 | 026-01M0599 | CABLE SWIVEL END EYELET | 1 |
| 81 | 014-0015013 | 35mm INTERNAL SNAP RING | 1 |
| 82 | 022-0008032 | STRAP HANDLE | 2 |
| 83 | 020-0010002 | SNAP LINK | 1 |
| 84 | 016-0201007 | END CAP ϕ 1.00" (BLACK) | 1 |